

CONTRACT NO: 009540 FEDERAL AID NO: 0167(057)
CONTRACT TITLE: SR167, I-5 TO SR 509 NEW EXPRESSWAY PROJECT
CHANGE ORDER NO: 32 OPL COST DELAY

PRIME CONTRACTOR: XXXXXXXXXX GUY F. ATKINSON CONSTRUCTION, LLC.
707 SOUTH GRADY WAY SUITE 500
RENTON WA 98057-3224

(X) Ordered by Engineer under the terms of Section 1-04.4 of the Standard Specifications
() Change proposed by Contractor

<p>ENDORSED BY: <u><i>Signature on file</i></u></p>	<p>SURETY CONSENT:</p>
<p>CONTRACTOR SIGNATURE <u>Jun 13, 2024</u></p> <p>DATE</p>	<p>ATTORNEY IN FACT _____</p> <p>DATE</p>

ORIGINAL CONTRACT AMOUNT:	375,988,856.00
CURRENT CONTRACT AMOUNT:	380,744,245.70
ESTIMATED NET CHANGE THIS ORDER:	3,811,018.48
ESTIMATED CONTRACT TOTAL AFTER CHANGE:	384,555,264.18

Signature Required: Project Engineer State Construction Engineer
 Regional Administrator Other Agency

<p><u><i>Signature on file</i></u></p>	<p><u><i>Signature on file</i></u></p>						
<p>PROJECT ENGINEER SIGNATURE <u>Jun 18, 2024</u></p> <p>DATE</p>	<p>STATE CONSTRUCTION ENGINEER SIGNATURE <u>Jun 18, 2024</u></p> <p>DATE</p>						
<p><u><i>Signature on file</i></u></p>	<p>OTHER APPROVAL WHEN REQUIRED</p>						
<p>REGIONAL ADMINISTRATOR SIGNATURE <u>Jun 18, 2024</u></p> <p>DATE</p>	<table style="width: 100%;"> <tr> <td style="width: 80%;">SIGNATURE</td> <td style="width: 20%;">DATE</td> </tr> <tr> <td>_____</td> <td>_____</td> </tr> <tr> <td>REPRESENTING</td> <td></td> </tr> </table>	SIGNATURE	DATE	_____	_____	REPRESENTING	
SIGNATURE	DATE						
_____	_____						
REPRESENTING							

CONTRACT NO: 009540

CHANGE ORDER NO: 32

All work, materials, and measurements to be in accordance with the provisions of the Standard Specifications and Special Provisions for the type of construction involved.

This contract is revised as follows:

Description:

This Change Order compensates the Design-Builder for additional Work associated with project impacts caused by the delay to the Prior Relocation of the Olympic Pipeline (OPL), per RFP Section 2.10.9.8.

Construction Requirements:

The Design-Builder shall store, protect, rehandle, and place stockpiled material for the new SR 167 diverging diamond interchange (DDI) with I-5 embankment construction. Perform all erosion control measures necessary to establish the stockpile site as shown on page 4 of this Change Order.

The Design-Builder shall install and maintain a pump bypass system for the temporary diversion of Hylebos Creek. The pump bypass system shall be in place until OPL has successfully relocated the petroleum pipeline. The pump bypass shall be designed and operated to ensure backwater of the existing Hylebos Creek does not impact OPL's Prior Relocation operations.

Measurement:

No specific unit of measure shall apply to this new Lump Sum item, "CO#32, OPL Cost Delay".

Payment:

Payment will be made in accordance with Section 1-04.4 for the following new lump sum item:

"CO#32, OPL Cost Delay " Lump Sum.

This lump sum price shall be considered full compensation for all cost and efforts associated with this Change Order.

Contract Time:

No extension of Contract Time is granted as a result of this Change Order.

WASHINGTON STATE
 DEPARTMENT OF TRANSPORTATION
 CHANGE ORDER

DATE:06/07/24
 PAGE 3 of 4

CONTRACT NO:009540	CHANGE ORDER NO: 32
--------------------	---------------------

ITEM NO	GROUP NO	STD ITEM	UNIT OF MEASURE	UNIT PRICE	EST QTY CHANGE	EST AMT CHANGE
---------	----------	----------	-----------------	------------	----------------	----------------

ITEM	DESCRIPTION:	CO#032 OPL COST DELAY				
1024	05	L.S.		0.00	0.00	3,811,018.48

AMOUNT TOTAL

 3,811,018.48
 =====

GENERAL NOTES:

- SEE APPROVED RIGHT-OF-WAY PLANS FOR RIGHT-OF-WAY INFORMATION.
- CLEAR AND GRUB SHALL NOT EXTEND BEYOND HIGH VISIBILITY FENCE LIMITS.
- EXISTING VEGETATION OUTSIDE OF THE CLEARING AND GRUBBING LIMITS SHALL BE PROTECTED AND NOT DISTURBED.
- SEE ED01 FOR ADDITIONAL TEMPORARY EROSION CONTROL NOTES.

LEGEND	
	PROPOSED DRAIN PIPE
	HIGH-VISIBILITY SILT FENCE (WSDOT STD. PLAN I-30.16-01 & I-30.17-01)
	STABILIZED CONSTRUCTION ENTRANCE (WSDOT STD PLAN I-80.10-02)
	PROPOSED CLEAR AND GRUB LINE
	PROPOSED FILL LINE
	PROPOSED MAJOR CONTOUR
	PROPOSED MINOR CONTOUR
	EXISTING MAJOR CONTOUR
	EXISTING MINOR CONTOUR
	IMPACT AREA LINE
	ORDINARY HIGH WATER LINE
	WETLAND BOUNDARY

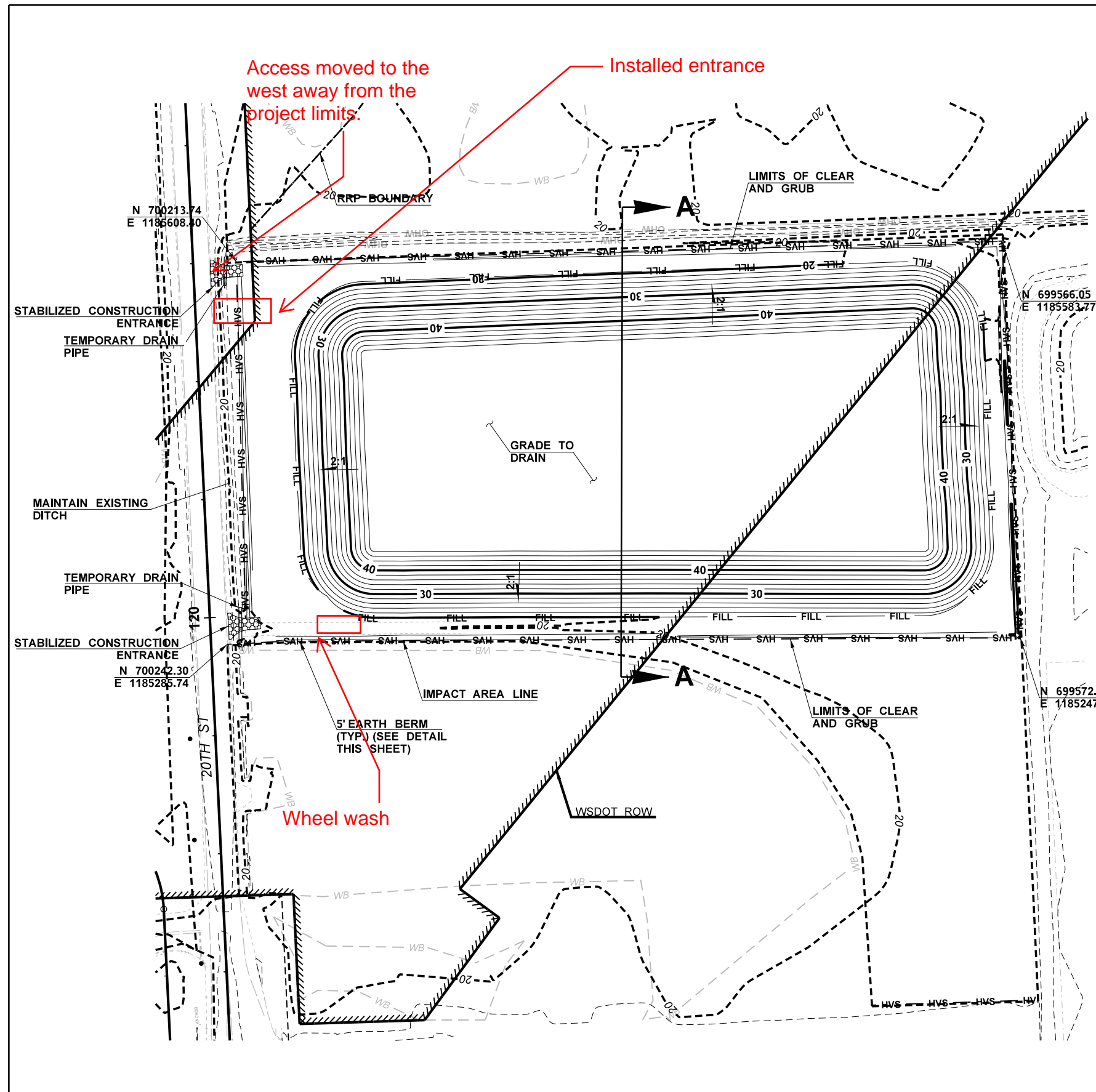
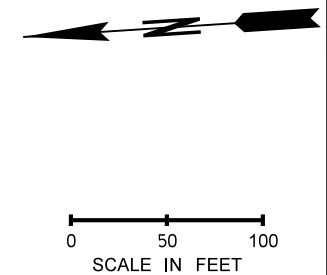
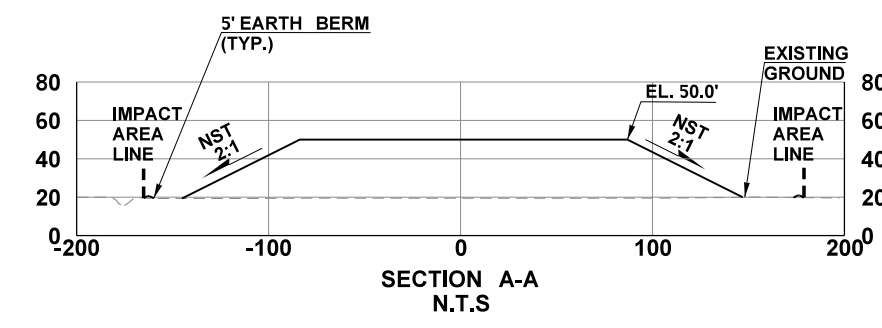
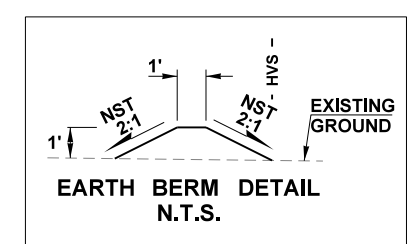

FILE NAME	c:\pwworking\jacobs_b\schradnj\d0421259\XL5466_PS_YGP01.dgn			REGION NO.	STATE	FED.AID PROJ.NO.		<h1>PRELIMINARY</h1>		SR 167 I-5 TO SR 509 NEW EXPRESSWAY	PLAN REF NO
TIME	10:01:38 AM			10	WASH						YGP01
DATE	4/20/2023			JOB NUMBER							SHEET
PLOTTED BY	SchradNJ			CONTRACT NO.		LOCATION NO.					OF
DESIGNED BY	N. SCHRADER			C9764							SHEETS
ENTERED BY	N. SCHRADER										
CHECKED BY	E. EVANS										
PROJ. ENGR.	T. SLIMAK										
REGIONAL ADM.	S. ROARK			REVISION		DATE	BY				

ATKINSON / Jacobs
 CONSTRUCTION

20TH ST YARD GRADING PLAN